

## SPECIFICATIONS OF FLATS

<b>PARKING</b>	Ample Parking
<b>LIFT</b>	Lift with backup
<b>STRUCTURE</b>	Standard R.C.C. frame structure for high quality
<b>WALL</b>	High quality cement blocks or Brick masonry 9" thick for external and 6" thick for internal walls.
<b>PLASTER</b>	Internal plaster in Gypsum and external sand faced plaster.
<b>DOORS</b>	Main doors(Frame with decorative laminated flush door) Other doors(Pre-cast cement frame with laminated flush door)
<b>KITCHEN OTTA</b>	Granite top with S.S. Sink and glazed tile dado upto 7' level.
<b>PLUMBING</b>	Concealed plumbing with best quality sanitary ware and S.S. fittings of good quality.
<b>FLOORING/DADO</b>	Vitrified tiles in all rooms, Glazed tiles in W.C. bath upto 7' level.
<b>WINDOWS</b>	Aluminium three track sliding windows with M.S. Grill.
<b>ELECTRIFICATION</b>	Bectrification of copper wiring in each room 3.5 points and power point in kitchen and bathroom. Geysr Pl., provision of T.V. and telephone Pnt. in living and master bedroom
<b>COLOUR</b>	Plastic paint inside and Apex paint outside, Oil paint to all door frames and window grill

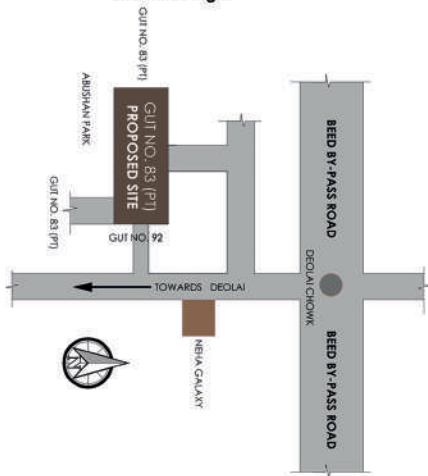

LOCATION PLAN

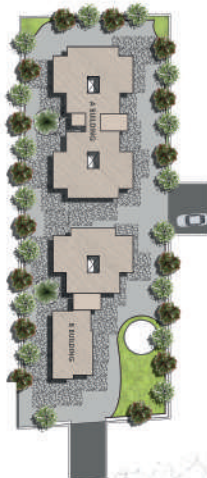

SITE PLAN

## GOLDEN PALM APARTMENT

DEOLAI, AURANGABAD



Ultimate in *STYLE* and *COMFORT*

**SITE ADDRESS:** Gut no: 83(P).. near Abhushan park, Deolai, Beed by-pass road, Aurangabad

**OFFICE ADDRESS:** 70 Suvaraneel House, Dashmeshnagar, Aurangabad-431005.

**A PROJECT BY: RAKA AND BAHETI ASSOCIATES**

**FOR BOOKING CONTACT: SUNIL M RAKA (+91 9423189136) & VINEET RAKA (+91 8552004684)**

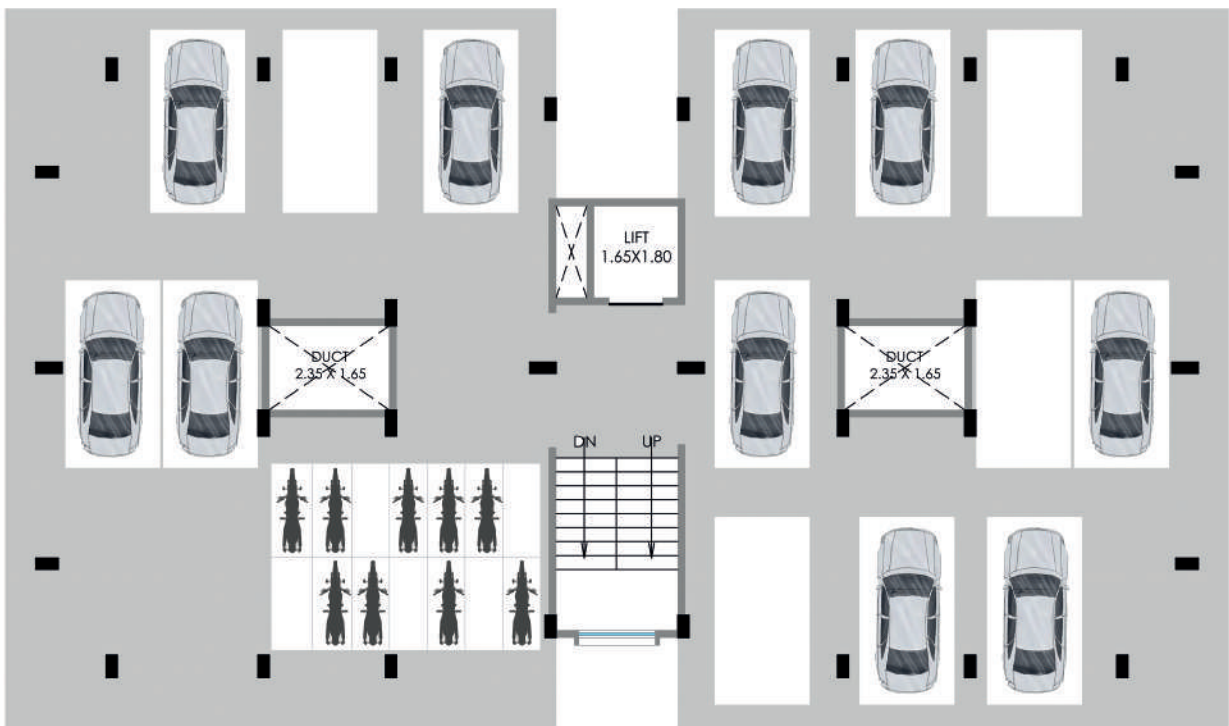

**PARKING FLOOR PLAN**



**STILT FIRST FLOOR/ STILT THIRD FLOOR PLAN**





**STILT FLOOR PLAN**



**STILT SECOND FLOOR PLAN**



